



# ***USER MANUAL***



## Introduction

Congratulations on the purchase of your New Kreepy Krauly - now with more cleaning and vacuuming muscle.

It is essential that you read this manual thoroughly prior to assembly and installation to ensure that your New Kreepy Krauly performs properly.

Correctly installed in an efficiently operating pool system, your New Kreepy Krauly will give you years of satisfaction.

The New Kreepy Krauly automatic swimming pool cleaner is an hydraulically operated machine.

Throughout its life in the pool the New Kreepy Krauly will give you excellent service, cleaning and removing dirt and deposits thereby reducing chemical demand.

If you wish to take the machine out of the water while swimming, detach the hose from the machine, keep the machine and hose out of the sun and ensure that the hose is kept in a straight position.



## Component Checklist

- 1....Kreepy Krauly assembly
- 2....Footpad
- 3....Suction seal
- 4....Clip on wing
- 5....Bumper assembly
- 6....Regulator valve
- 7....Hose weight (3)
- 8....Adapter cuff
- 9....Hose protector
- 10..Hose adaptor
- 11..8 x 1.2m hoses (kombi pack)

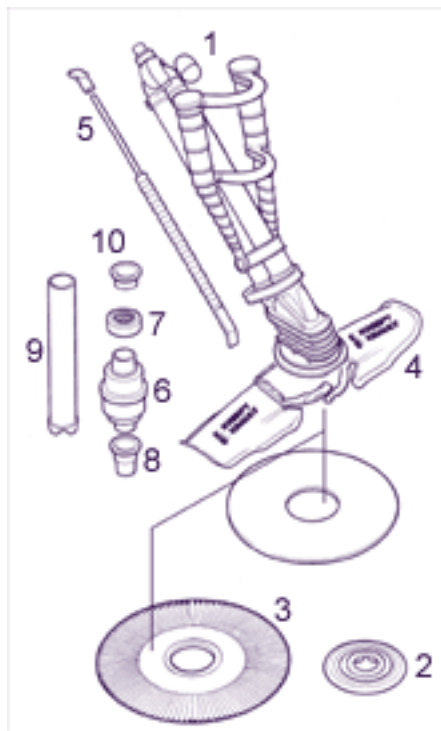

## How to assemble your new Kreepy Krauly

Please follow the step-by-step instructions carefully to assemble your New Kreepy Krauly. If you experience any difficulty or require any advice please contact your pool professional. Follow the instructions as shown to the right.

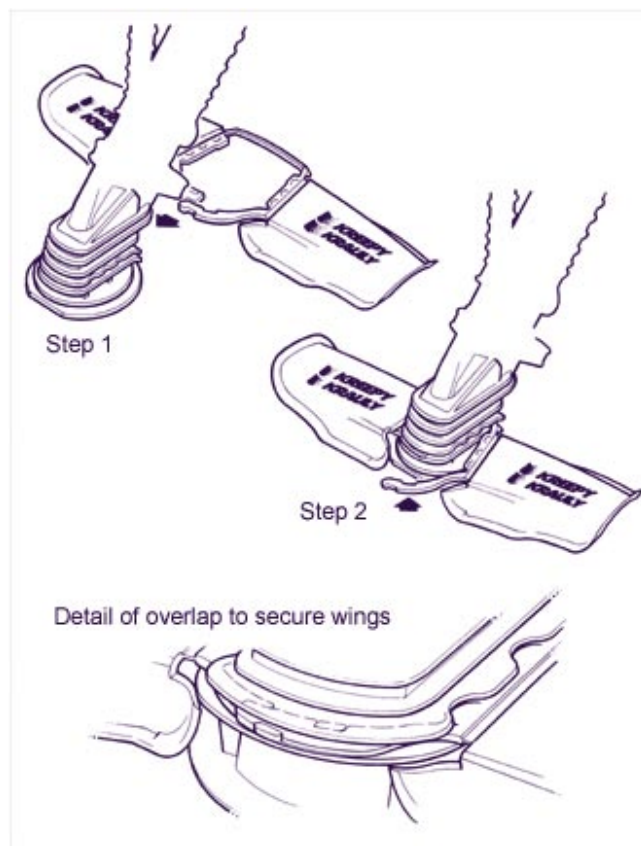

## Fitting the Seal

### Important

It is the task of the pool owner to check all pool equipment monthly. The footpad and suction seal are wearing parts and should be replaced if worn.

N.B. Wearing parts do not fall under the exclusive five-year warranty.

### Fitting the Pleated Seal:

Ensure that the footpad is removed before fitting the pleated seal.

The seal should be placed at the bottom of the machine with the pleats facing upwards, the footpad should then be attached to the lip at the bottom of the machine which will keep the seal in place. The seal must be installed flat side down, pleated contoured side up. It should rotate freely. Replace footpad.

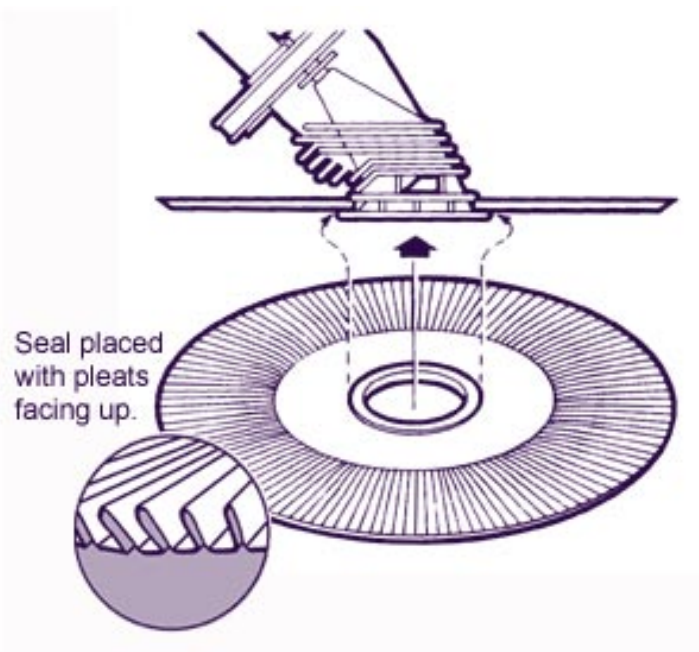

## Fiting the Bumper Assembly

You are supplied with a bumper adaptor.

Insert the flat end of the bumper assembly into the slot at the bottom of the main body. Then slip the opposite end of the bumper assembly into the socket in the adaptor.

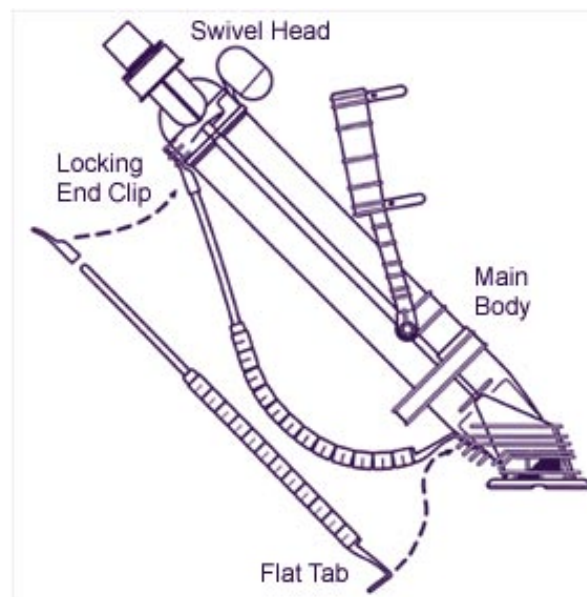

## Hose Assembly and Weights

The exclusive five-year warranty is only valid if the machine is operating with genuine Kreepy Krauly hose. N.B. Kreepy Krauly hose is specially constructed for optimum performance and is protected by a three-year warranty against factory defect.

The New Kreepy Krauly hose comes in sections which must be assembled. You'll need enough sections to reach from where the New Kreepy Krauly is connected to the farthest part of your pool, plus one section.

Twist and push the female ends to the male ends after dipping the ends into the pool to wet them. Push until the hose fits snugly. Do not force as this will hamper dismantling. Continue until you've connected all the sections you need.

You will also have to attach hose weights to the hose to neutralise the hose's buoyancy in the water. You are supplied with 3 hose weights. Fit one hose weight in the middle of each of the first 3 sections of the hose.

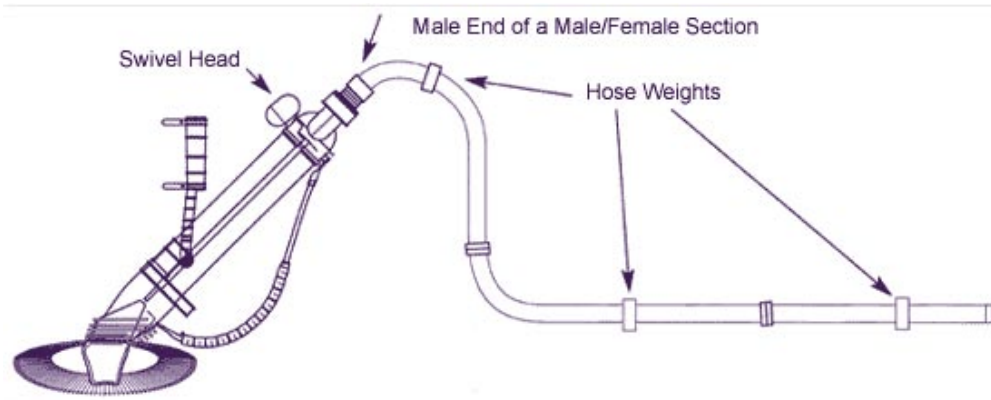

## Installation

Thoroughly clean and backwash the filter to ensure it is free from dirt and debris otherwise your New Kreepy Krauly will not work.

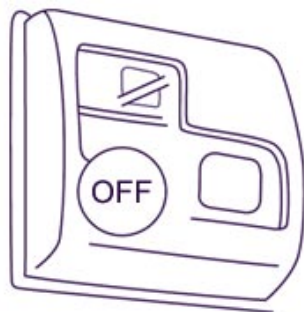

A: Switch the pump off



B: Clean skimmer and leaf strainer. Put it back.

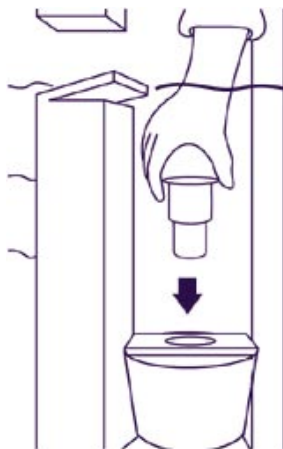

C: Place valve adaptor cuff into vacuum lid.

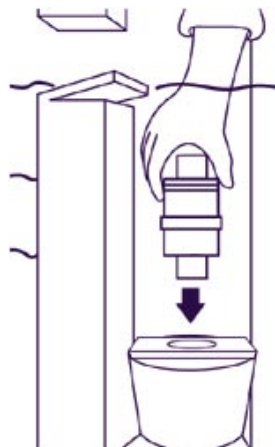

D: Place Auto-Skim Valve into valve adaptor cuff.



## Installation continued

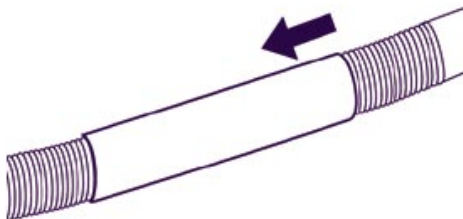

E: Slide hose protector over hose.

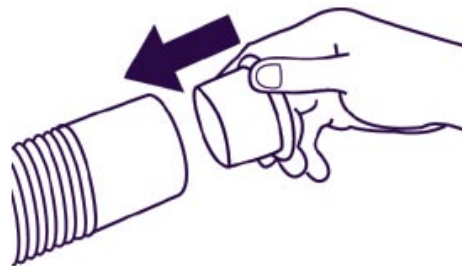

F: Place hose adaptor into hose.



G: Place the New Kreepy Krauly into the pool and allow it to sink to the floor. Feed the hose down into the pool until it is completely filled with water. No air must be in the hose when it is fitted into the valve adaptor cuff.

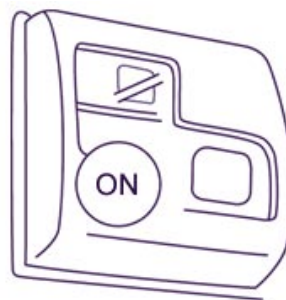

H: Switch pump on.  
Your fully-assembled New Kreepy Krauly will start pulsating immediately.

## Balancing

To determine the correct hose balance, turn the pump off and observe the New Kreepy Krauly. The hose balance is correct when New Kreepy Krauly's seal rests flat on the pool floor and the drive tubes make a 45° angle with the floor. New Kreepy Krauly achieves the best cleaning coverage when the hose neither weighs down nor pulls up on the unit.

You must always have 3 hose weights on the hose. The weights are designed to balance the New Kreepy Krauly correctly. The first weight should be in the middle of the length nearest to your New Kreepy Krauly. This controls the movement in the shallow end of your pool. To control the movement in the deep end, the second and third weights should be placed half-way up the second and third lengths of hose. The balance between the first and second weights regulates the movement around the pool.

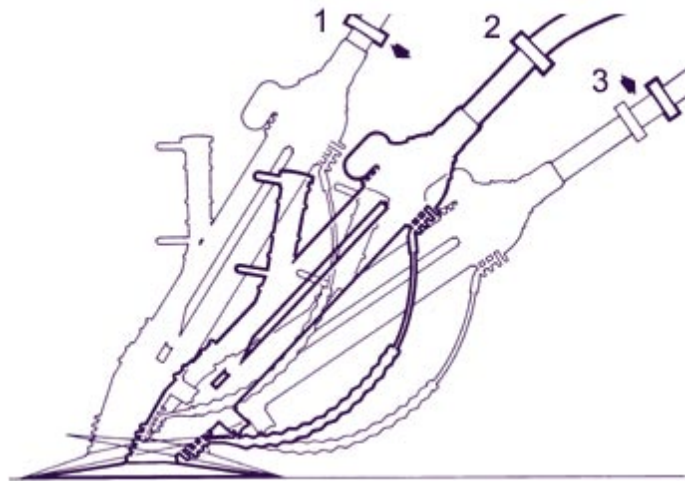

### 1. Hose Too Light.

If the hose rises toward the surface at an angle greater than 45°, move the weights closer to New Kreepy Krauly or move the first two weights closer to each other.

### 2. Correct Hose Balance.

### 3. Hose too heavy.

If the hose sags downward at an angle less than 45° move the weights away from New

## Installation problems

### Pool Steps

If the New Kreepy Krauly sticks on the steps which are the furthest points from the skimmer, prevent the New Kreepy Krauly from reaching there by reducing the length of the hose from the valve end. Manually brush the uncleaned pool area towards the area covered by the New Kreepy Krauly.

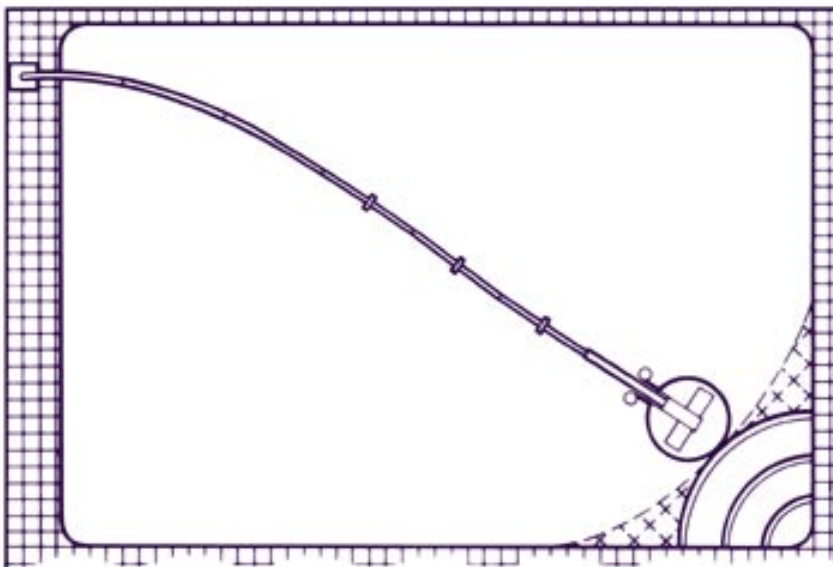

## Troubleshooting 1 of 4

### **New Kreepy Krauly is pulsating rapidly but remains stationary or travels very slowly:**

- 1 If the footpad's tread is worn or the footpad is not fitted, replacement is needed.
- 2 If the skimmer vacuum lid and Auto-Skim Valve does not fit, reinstall vacuum lid and replace Auto-Skim Valve.
- 3 If the pleated seal's pleats are facing the pool floor, then it is fitted upside down. Remove and refit.
- 4 If the Auto-Skim Valve is jammed then remove, clean and replace the Auto-Skim valve.
- 5 If you have a fibreglass pool, it is essential that a pleated seal is fitted.

### **New Kreepy Krauly auto-skim valve is making noises:**

- 1 Auto-Skim Valve has been fitted too close to water level and a vortex forms. Place a tennis ball into the weir or install the valve inverted by removing the hose adaptor from the slide end and fitting the hose directly to the fixed end.

### **New Kreepy Krauly is sticking on steps:**

- 1 Use return flow to push New Kreepy Krauly hose away from the steps.
- 2 Cut the top of the bumper strap by 3-4 cm.
- 3 Shorten the hose so that the machine cannot reach the steps.



## Troubleshooting 2 of 4

### **New Kreepy Krauly climbs out of the pool drawing in air:**

- 1 Auto-Skim valve not installed. Install valve.
- 2 Pool wall concave. Install a Dive Float Restrictor.

### **New Kreepy Krauly sticks on the wall:**

- 1 Worn footpad. Replace.

### **New Kreepy Krauly is cleaning pool in regular pattern:**

- 1 Ensure all 3 hose weights are being used.
- 2 Hose length is kinked. Remove all the hoses from the pool, separate them, place them all on the ground and see which one has a kink. Replace kinked hose with a new length.
- 3 Swivel not allowing machine free movement of hose. Replace with a new swivel.

### **New Kreepy Krauly leaving patches:**

- 1 No hose weights are installed or only one hose weight is installed. Install all 3 hose weights.
- 2 Return flow is blowing the hose away. Adjust eyeball downwards.
- 3 Time switch is not running for long enough. Reset time switch.

### **New Kreepy Krauly ties itself in knots:**

- 1 Swivel is not giving New Kreepy Krauly free movement. Replace with new swivel.
- 2 New Kreepy Krauly hose is kinked. Remove all the hoses from the pool, separate the lengths, place them all on the ground and see which one has a kink. Replace kinked hose with a new length.
- 3 Hose weights are not in the correct place. Reinstall the hose weights.



## Troubleshooting 3 of 4

### **New Kreepy Krauly travels around the water line in one direction only:**

- 1 The main body and swivel head could be out of line, adjust the New Kreepy Krauly so that the main body and swivel head are perfectly aligned.

### **Wall and Floor are at 90°:**

Kreepy Krauly will only clean the bottom of the pool. For assistance contact your pool professional.

### **Fibreglass pool - New Kreepy Krauly not going up the walls:**

- 1 Pleated seal upside down. 'This side up' must not be on the pool floor.

### **New Kreepy Krauly travels too slowly or does not pulsate:**

- 1 Check Auto-Skim Valve fitting properly in weir.
- 2 Empty skimmer and pump leaf trap of any debris.
- 3 Backwash filter.
- 4 If problem persists, contact your local Kreepy Krauly agent.



## Troubleshooting 4 of 4

### **New Kreepy Krauly does not sit flat on the bottom of the pool:**

- 1 Adjust hose weights. First weight in the middle of the first section, second in the middle of the second section, third in the middle of the third section.

### **New Kreepy Krauly stays at one end of the pool:**

- 1 Adjust hose weights.
- 2 Turn down the return flows to prevent return flow water from blowing New Kreepy Krauly hose away.

### **New Kreepy Krauly slows down and stops completely:**

- 1 Check that nothing is jamming the Flow Valve by removing the retaining plate underneath the Kreepy Krauly.

#### **How to clear the flow valve:**

- 1 Remove footpad.
- 2 Remove baffle plate by pressing plastic clips inward.
- 3 Clear flow valve.
- 4 Replace baffle plate and footpad.

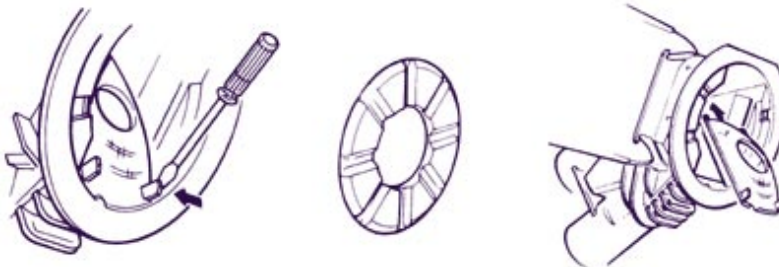

## Warranty

We warrant your new pool cleaner machine unit to be free from defects in material and workmanship for 5 YEARS from date of purchase, subject to our standard conditions of sale. Please return the attached reply card to ensure your warranty is recorded.

### Standard Conditions of Sale.

The WARRANTY excludes:

- Defects in the hose. (Genuine Kreepy Krauly hoses are warranted for three years against manufactured defects.)
- Kreepy Krauly warranty terms and conditions apply.
- Normal wear and tear of the Footpad and Suction seal. These must be checked monthly and replaced when worn.
- Damage due to abnormal use, lack of care, negligence, undue exposure to sun, heat, and all such acts or omissions beyond our control.
- Damage caused by an incorrect chemical balance in the swimming pool.
- Any obligation other than the obligation to repair or replace defective parts.
- Discolouration of parts. (Your New Kreepy Krauly may become discoloured as a result of being subjected to use in your swimming pool. Such discolouration, however, shall in no way affect the cleaner's operating ability.)
- The New Kreepy Krauly Warranty is given in place of all warranties, guarantees, express or implied, of merchantability, fitness for particular purpose, or otherwise.\*  
The warranty is not transferable.

